

# 680 Casement

## Component Identification

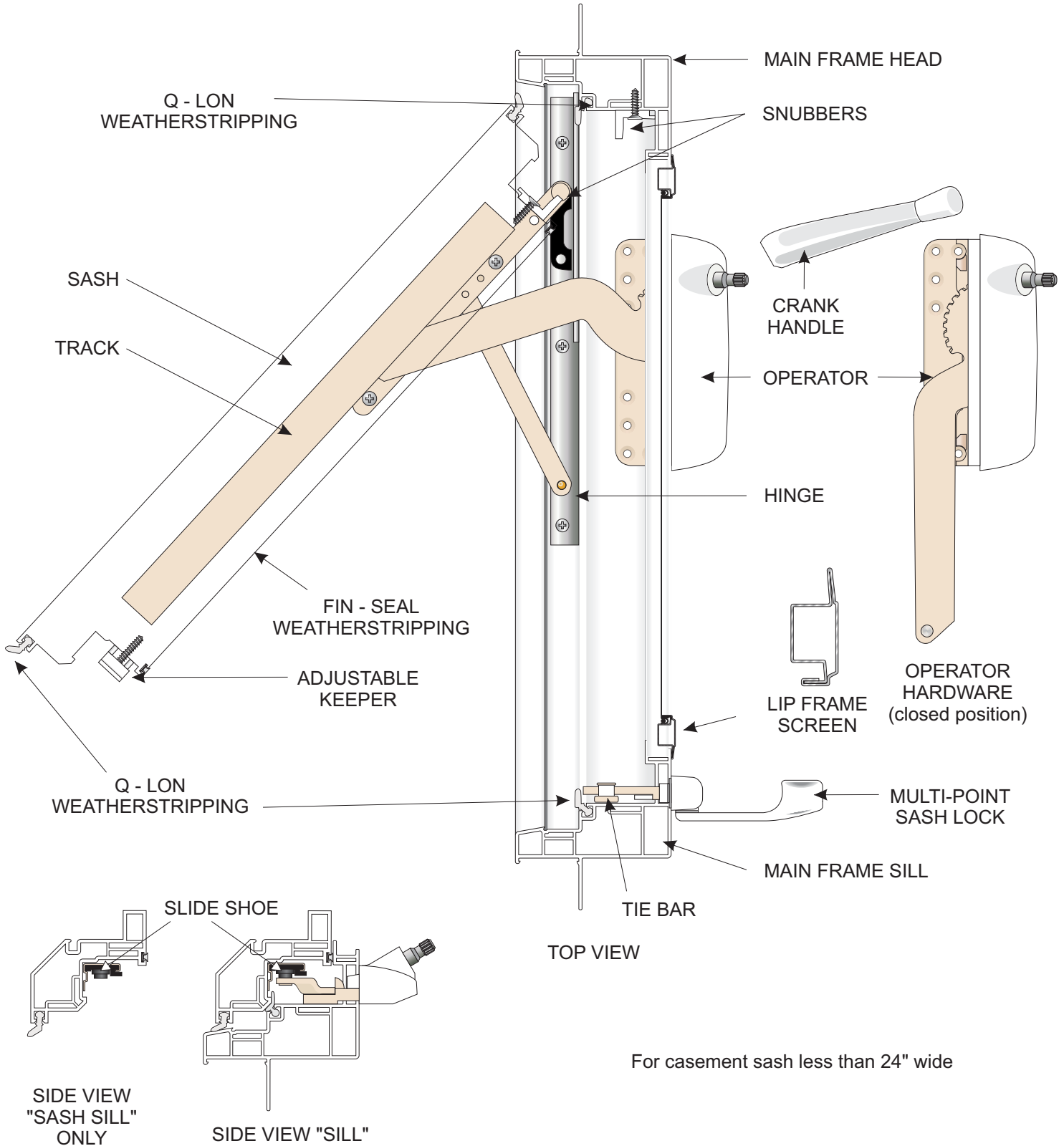

# 680 Casement Component Identification

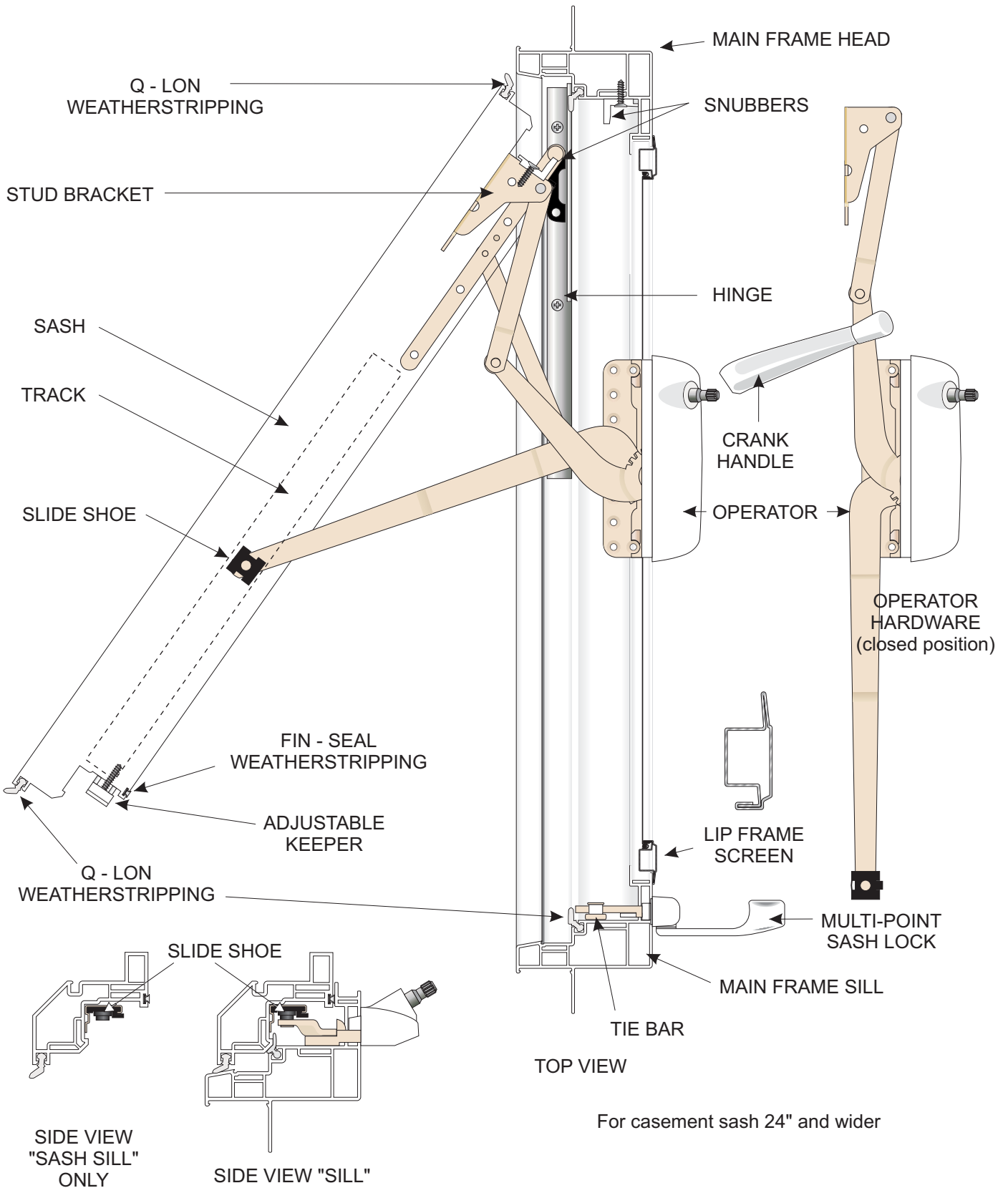

# 680 Casement Parts List

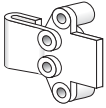

**TIE BAR GUIDE**  
40837  
BH168300

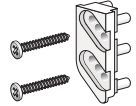

**LH  $\square$  MULTI-POINT  
ADJUSTABLE KEEPER**  
40710  
BH168200

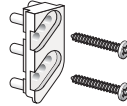

**RH  $\square$  MULTI-POINT  
ADJUSTABLE KEEPER**  
40709  
BH168100

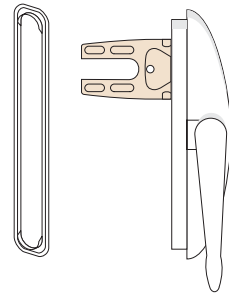

**RH/LH MULTI-POINT  
CASEMENT LOCK OPERATOR**  
24.31.32.002 - WHITE - BH214201  
24.31.24.002 - ALMOND - BH214254  
24.31.41.002 - CLAY - BH214251



**TIE BAR**  
2/0 (10.9") BH168700  
2/6 (14.9") US309315  
3/0 (22.9") BH168900  
3/6 (26.9") BH169000  
4/0 (34.9") BH169100  
4/6 (38.9") US309339  
5/0 (46.9") US309347  
5/6 (50.9") US309351  
6/0 (58.9") US309359



**SS TIE BAR**  
2/0 (10.9") BH178900  
2/6 (14.9") BH179000  
3/0 (22.9") BH179100  
3/6 (26.9") BH179200  
4/0 (34.9")  
4/6 (38.9") BH179300  
5/0 (46.9") BH179400  
5/6 (50.9") BH179500  
6/0 (58.9") BH179600

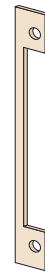

**LOCK  
SUPPORT PLATE**  
21600.92  
US309000



**CONTOUR KNOB**  
WHITE - US309401  
ALMOND - US309423  
CLAY - US309451



**FOLDING HANDLES**  
WHITE - US302401  
ALMOND - US302423  
CLAY - US302451

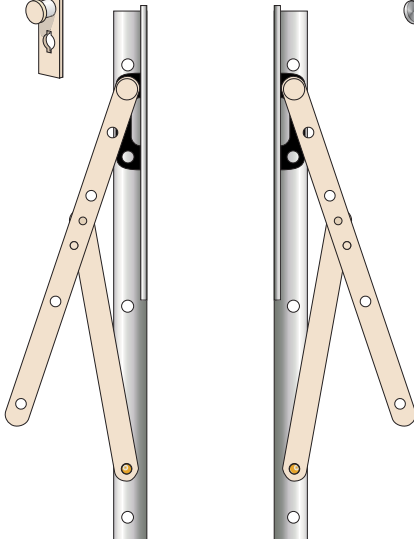

**L/H HINGE**  
14.02.00.001  
BH242700

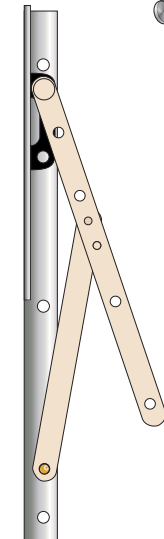

**R/H HINGE**  
14.02.00.002  
BH243900



**L/H S.S.  
HINGE**  
13.43.00.501  
BH214800

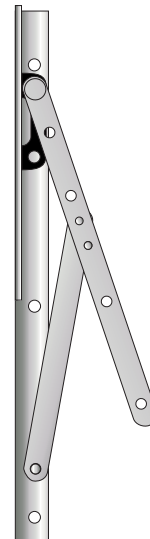

**R/H S.S.  
HINGE**  
13.43.00.502  
BH214900

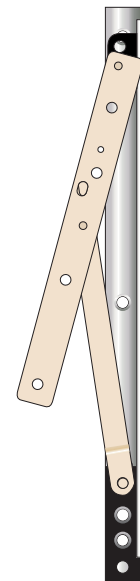

**LH HD HINGE**  
(Triple glaze sash)  
14.96.00.001 LL  
BH308700

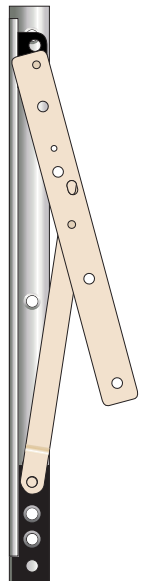

**RH HD HINGE**  
(Triple glaze sash)  
14.96.00.002 UL  
BH308800

# 680 Casement Parts List

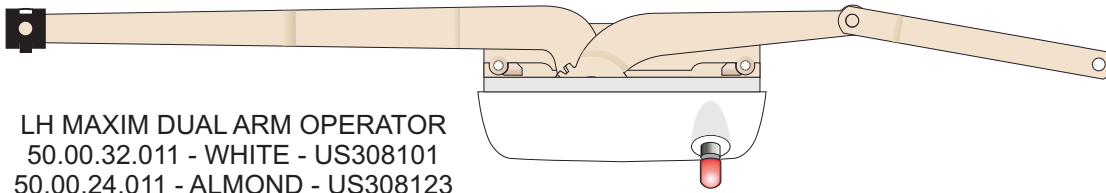

LH MAXIM DUAL ARM OPERATOR  
50.00.32.011 - WHITE - US308101  
50.00.24.011 - ALMOND - US308123  
50.00.41.011 - CLAY - US308151

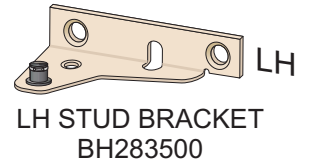

LH  
LH STUD BRACKET  
BH283500

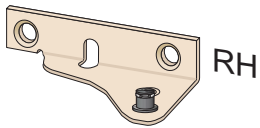

RH  
RH STUD BRACKET  
BH283600

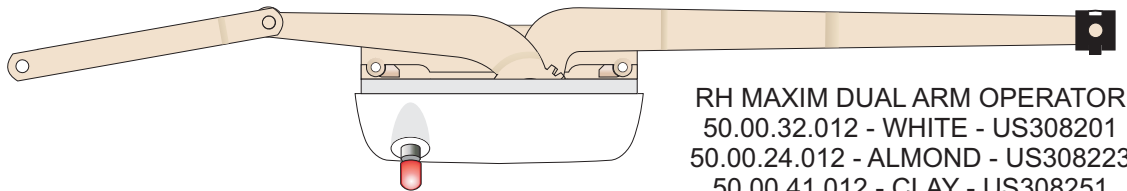

RH  
RH MAXIM DUAL ARM OPERATOR  
50.00.32.012 - WHITE - US308201  
50.00.24.012 - ALMOND - US308223  
50.00.41.012 - CLAY - US308251

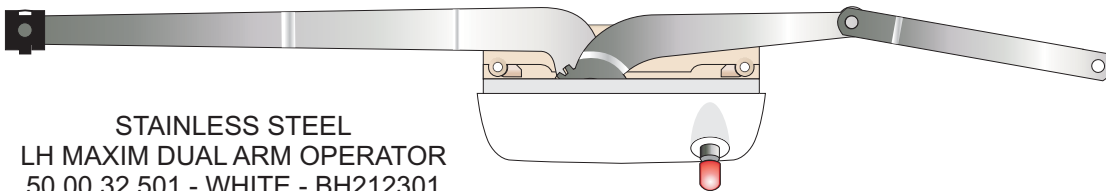

STAINLESS STEEL  
LH MAXIM DUAL ARM OPERATOR  
50.00.32.501 - WHITE - BH212301  
50.00.24.501 - ALMOND - BH212554  
50.00.41.511 - CLAY - BH212551

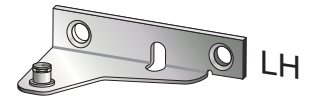

LH  
LH S.S. STUD BRACKET  
10680.00.0500 - BH213200

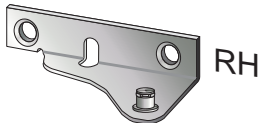

RH  
RH S.S. STUD BRACKET  
10681.00.0500 - BH213300

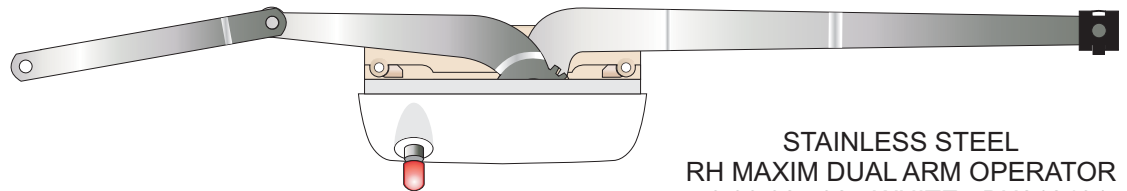

STAINLESS STEEL  
RH MAXIM DUAL ARM OPERATOR  
50.00.32.502 - WHITE - BH212401  
50.00.24.502 - ALMOND - BH212654  
50.00.41.512 - CLAY - BH212651

# 680 Casement / Awning

## Optional hardware



FOLDING HANDLES  
WHITE - US302401  
ALMOND - US302423  
CLAY - US302451

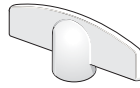

T HANDLE  
WHITE -  
ALMOND -  
CLAY -

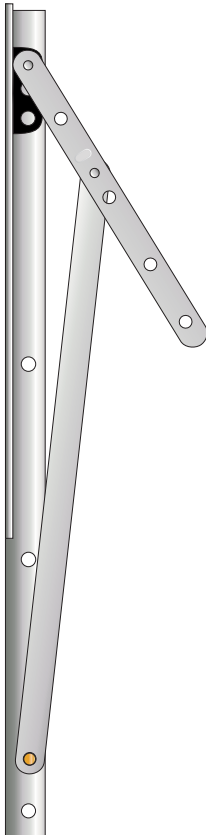

EGRESS HINGE  
LIMITED AVAILABILITY  
INCREASES SASH WIDTH EGRESS APROX 2"  
LEFT HINGE  
RIGHT HINGE

# 680 Extrusions

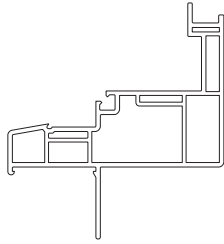

8546  
STANDARD 1 3/8  
WHITE - BV854601  
ALMOND - BV854654  
CLAY - BV851651  
BRONZE - BV854692

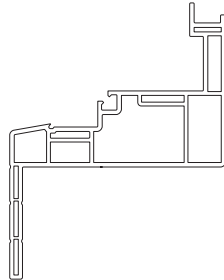

8550  
STUCCO  
WHITE - BV855001  
ALMOND - BV855054  
CLAY - BV855051  
BRONZE - BV855092

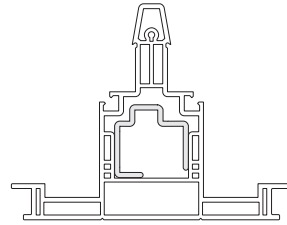

7199  
'T' BAR  
WHITE - BV719901  
ALMOND - BV719954  
CLAY - BV719951  
BRONZE - BV719992  
REINFORCEMENT  
BM193600

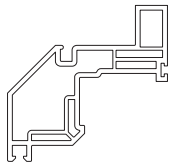

6375  
CASEMENT/AWNING SASH  
WHITE - BV637501  
ALMOND - BV637554  
CLAY - BV637551  
BRONZE - BV637592

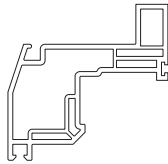

6941  
TRIPLE GLAZE  
CASEMENT/AWNING SASH  
WHITE - BV694101  
ALMOND - BV694154  
CLAY - BV694151  
BRONZE - BV694192

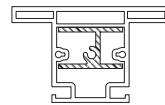

6456  
FLAT 'T' BAR  
WHITE - BV645601  
ALMOND - BV645654  
CLAY - BV645651  
BRONZE - BV645692  
REINFORCEMENT  
BM194200

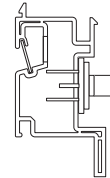

6980 VENTILATOR  
WHITE - BV698001  
ALMOND - BV698054  
CLAY - BV698051  
BRONZE - BV698092

# 680 Casement / Awning Clerestory hardware application

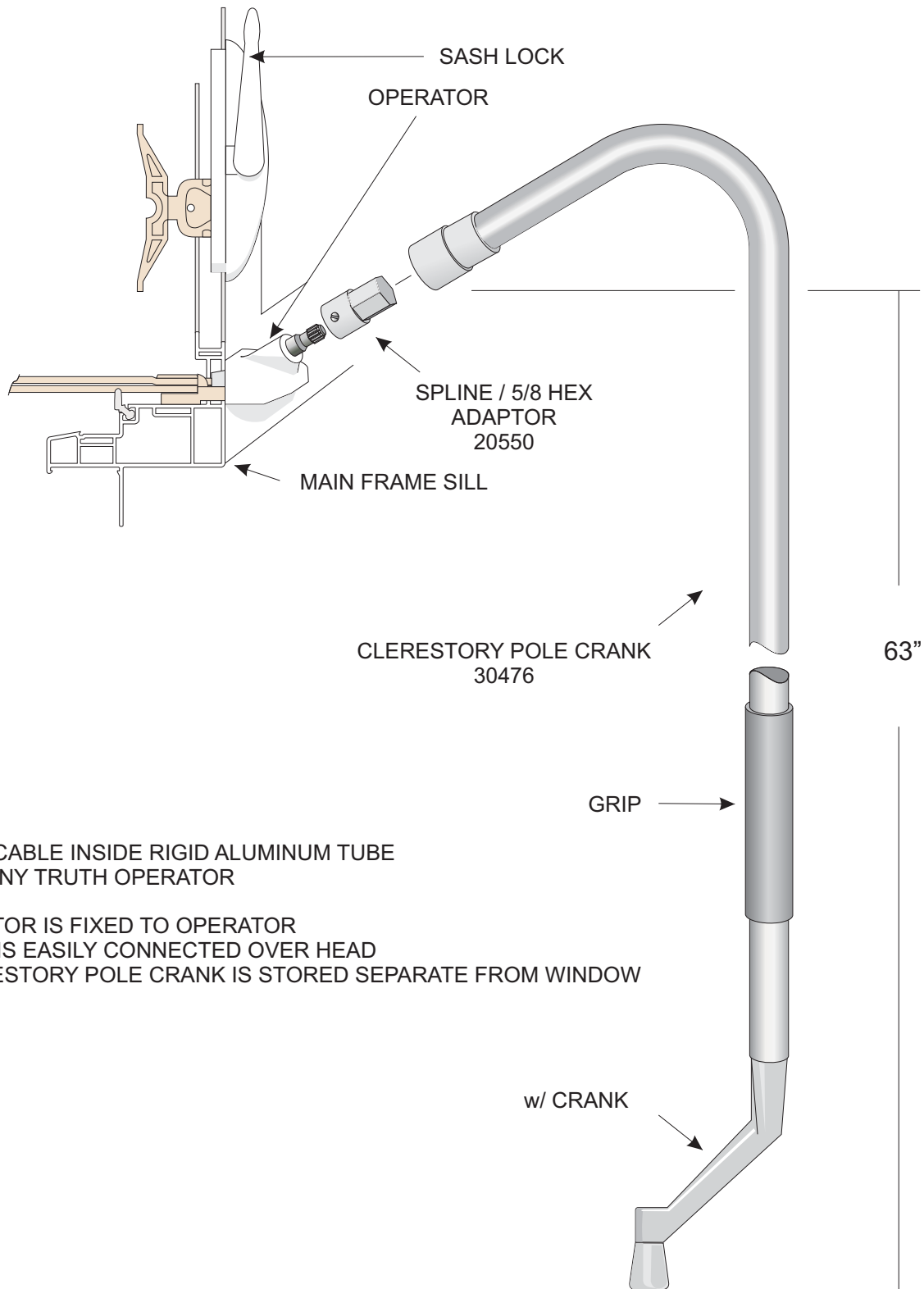

FLEX CABLE INSIDE RIGID ALUMINUM TUBE  
FITS ANY TRUTH OPERATOR

ADAPTOR IS FIXED TO OPERATOR  
POLE IS EASILY CONNECTED OVER HEAD  
CLERESTORY POLE CRANK IS STORED SEPARATE FROM WINDOW

# 680 Casement/Awning Latch Hardware Operation

## AWNING HARDWARE OPERATION

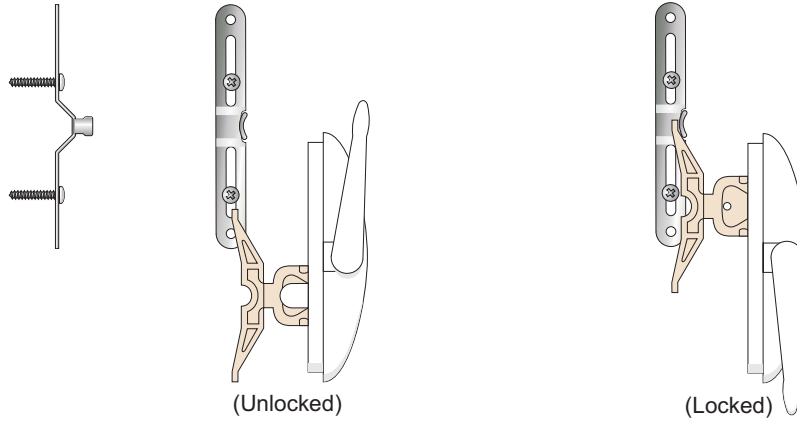

## CASEMENT HARDWARE OPERATION

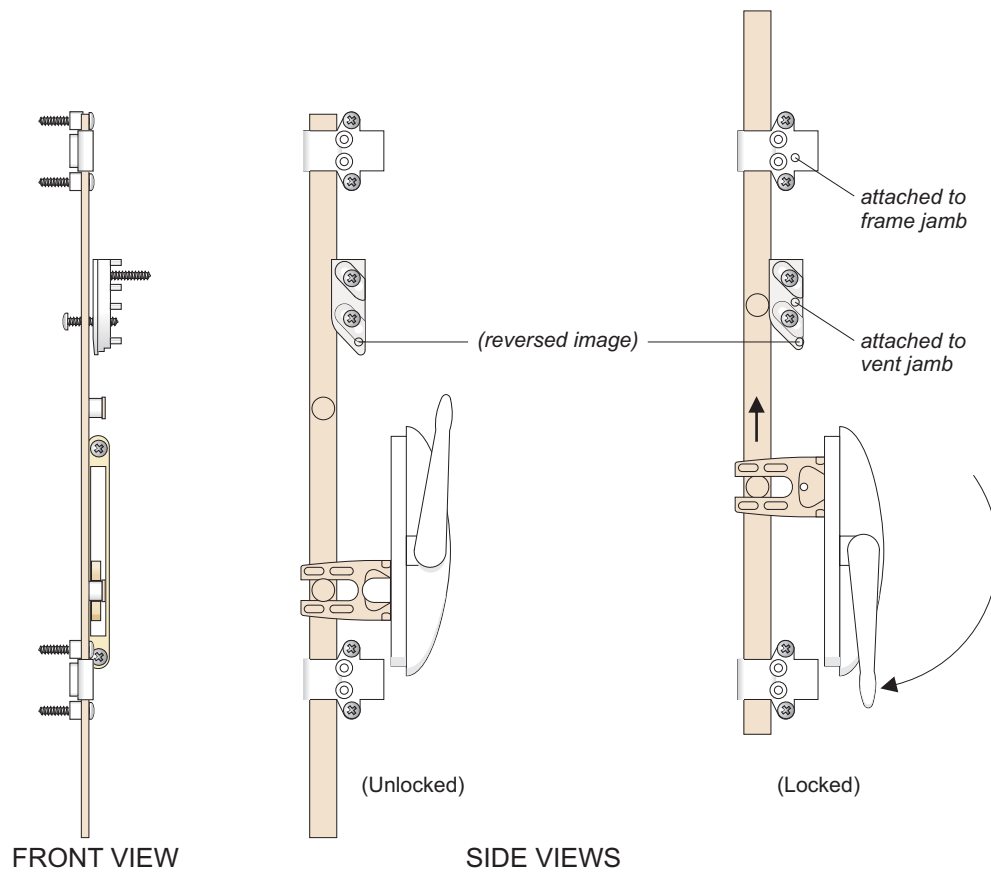



# 680 Casement/Awning Service

## Hinge Adjustment

Slight hinge adjustments can be made to square-up the sash to the main frame, reducing sash friction and improving operation. The pivot post is an off-centered cam allowing adjustments up to 1/4" on each side of the vent sash.

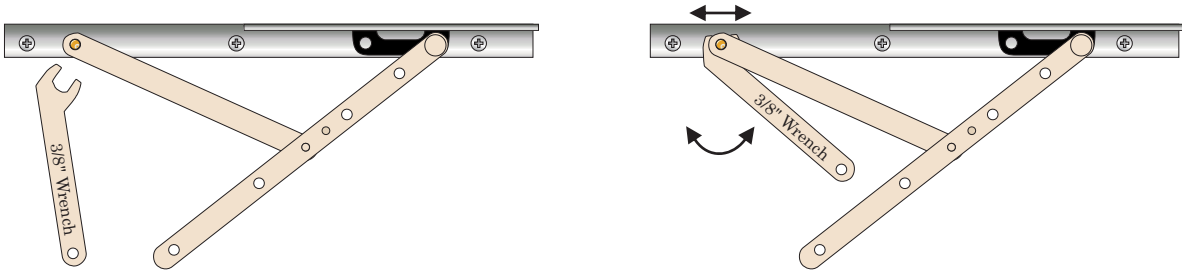

Use a thin 3/8" wrench when the pivot arm is attached or disengage the arm to use a standard wrench.

Rotate pivot post 90 degrees in either direction to move the sash location in the frame.

## Sash Removal

No screws need to be taken out to remove the sash from the main frame. Slide the track glide to a knock-out or out the end of the track to disengage the hardware from the sash frame.

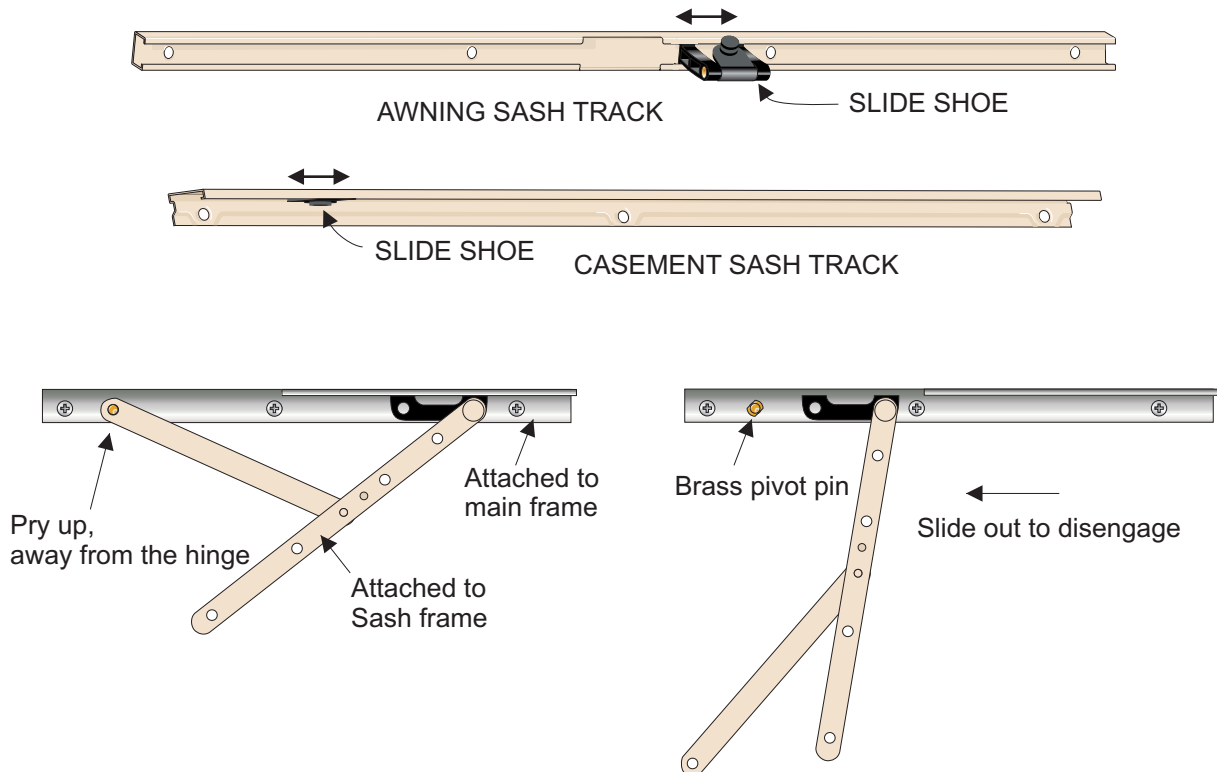

Pry up, away from the hinge

Attached to main frame

Attached to Sash frame

Brass pivot pin

Slide out to disengage

## 680 Casement Modified Snubber

### CONDITION:

DURING SASH CLOSURE, SASH OPERATION BINDS RESULTING IN INCREASED PRESSURE ON ROTO OPERATION AT NEAR CLOSED LOCATION. WHEN THE PAIR OF SNUBBERS STRIKE EACH OTHER RATHER THAN PASS BY ONE ANOTHER AS DESIGNED, THIS RESTRICTS SASH PASSAGE, CAUSING OPERATION TO BIND.

### SOLUTION:

RESHAPE THE SNUBBER PROFILE BY INCREASING THE BEVEL ON THE LEADING EDGE TO ALLOW PASSAGE (CLEARANCE) WITHOUT CHANGING THE GEOMETRY OF THE PART. TRIM OFF SHADED AREA (ILLUSTRATED BELOW).

### PROCEDURE:

MODIFY THE SNUBBER ON THE SASH ONLY. TEST THE SASH OPERATION TO VERIFY THE REPAIR WAS THE SOLUTION. IF BINDING CONTINUES, MODIFY THE SNUBBER LOCATED ON THE MAIN FRAME JAMB. TALLER CASEMENTS WILL USE DOUBLE SNUBBERS; EACH WILL REQUIRE MODIFICATION.

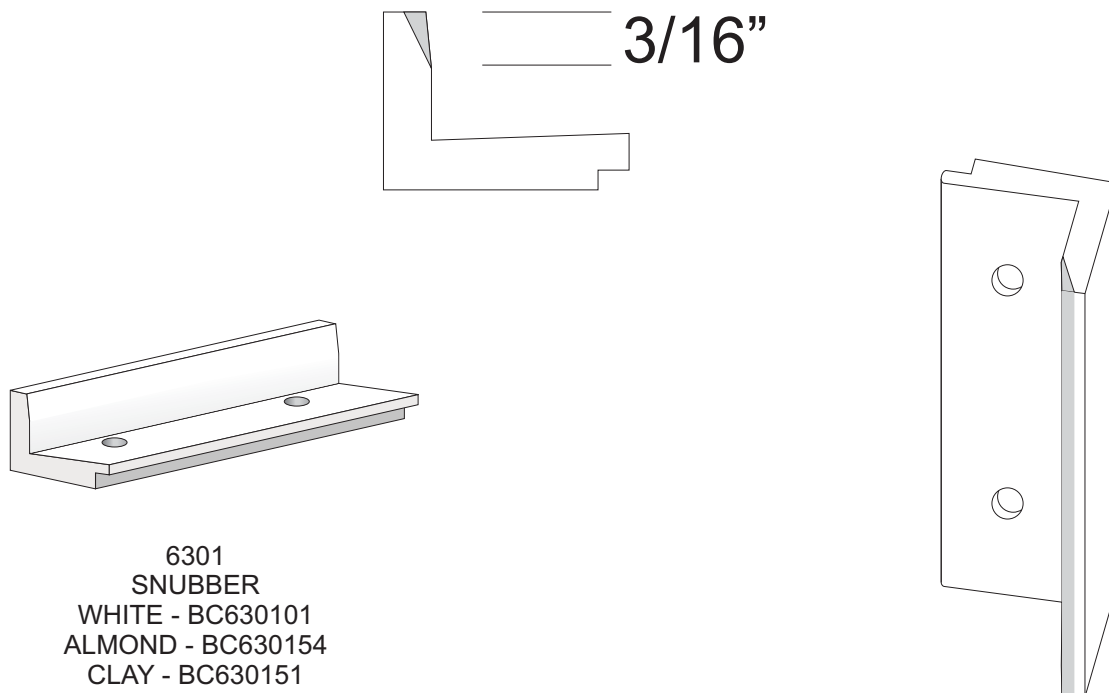

# 680 Series Window Screen

