

170 Sliding Patio Door Key Lock Installation

Service Technique

Remove Handle

Remove the 2 screws securing the interior handle to the face plate and remove.

Use locking pliers to remove the lock tail from the nylon pivot cam on the reverse side of the handle. This tail will not be reused as the longer key lock tail will be inserted in its place.

Remove the 2 screws securing the face plate and exterior handle pull to the door panel.

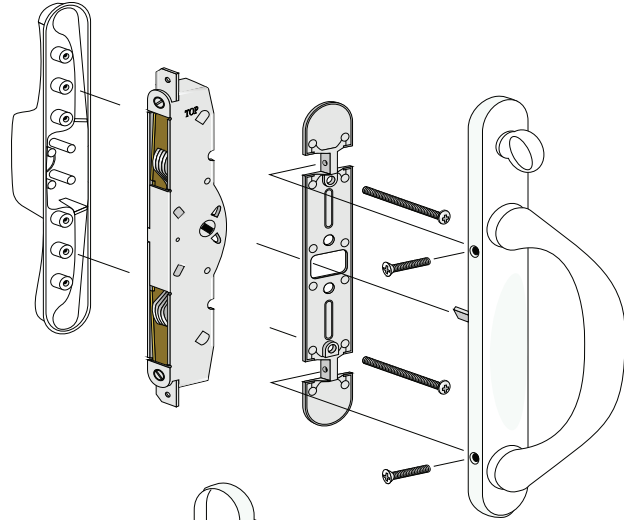

Lock Cylinder Prep.

The new key lock tail will measure 1 7/8" in length. 1/2" of the tail must be removed to a finished length of 1 3/8".

Use 2 pair of pliers to avoid the tail from breaking at the wrong location. If the tail breaks too short, it will not reach.

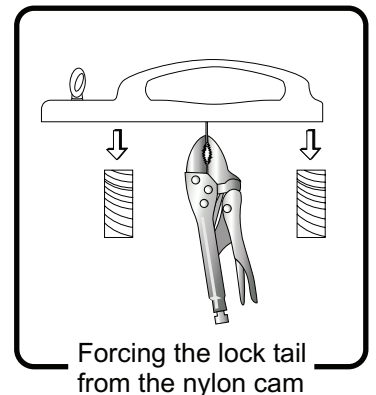
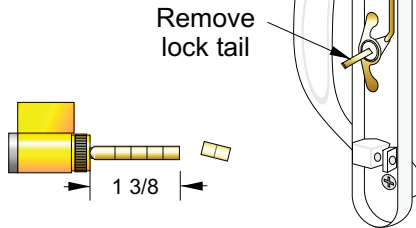

Reassembly

Place the exterior handle pull face up on a scrap piece of wood. Using a heavy punch, knock out the key lock slug. File any rough surfaces of the hole as this may bind on the lock cylinder when turning.

Insert the key lock into the back side of the handle pull as illustrated. Align the handle pull opposite the face plate to the door panel, inserting the lock tail through the mortise lock in the door. Reinstall the face plate screws through to the exterior door handle pull.

Test the key lock operation by inserting the key and turning to operate the lock.

Finish assembly by locating the interior handle, inserting the exposed lock tail into the nylon pivot cam in the handle mechanism.

Test the thumb turn once again to insure all moving parts are unrestricted and operating freely. Reinstall the 2 handle screws to the face plate.

