

# Reglaze Insulated Units

Replacing or reglazing insulated units in vinyl frame windows and doors.

- 1 From the interior of the window, using a thin, flexible putty knife, cut the glazing tape free by inserting the knife between the glass and the frame.

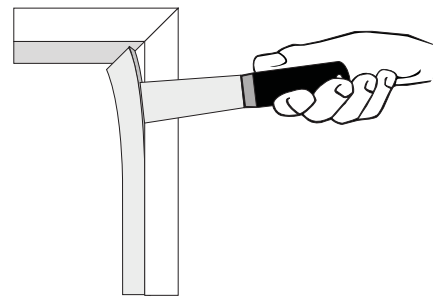
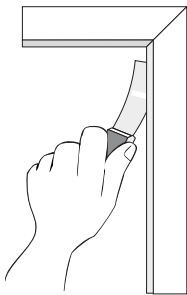

- 2 From the exterior, remove the glazing bead from the frame by prying with a stiff putty knife between the bead and the frame. Remove the insulated unit from the frame.

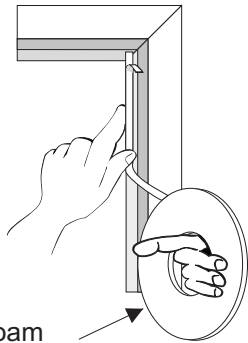

1/16"x3/8" foam double sided adhesive glazing tape.

- 3 Scrape all remaining tape debris from the glazing bed and apply new tape.

For best results cleaning the remaining glazing tape from the frame, use a dull, stiff putty knife by pushing the knife across the glazing surface of the vinyl frame.

Sharp tools can bite into the vinyl surface, making this procedure more difficult.

Removing all but a thin layer of adhesive is all that is needed to provide a smooth surface to apply new tape.

Do not leave exposed tape adhesive to open air for more than a few minutes.

Press the replacement unit into the tape firmly prior to installing glazing bead.

# Re-glaze continued

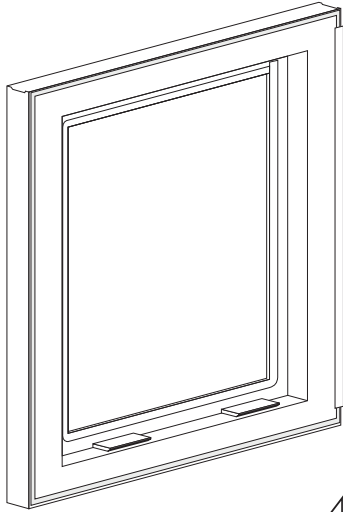

4

Position the glazing set blocks near each bottom corner so that the block does not make contact with the glass corner.

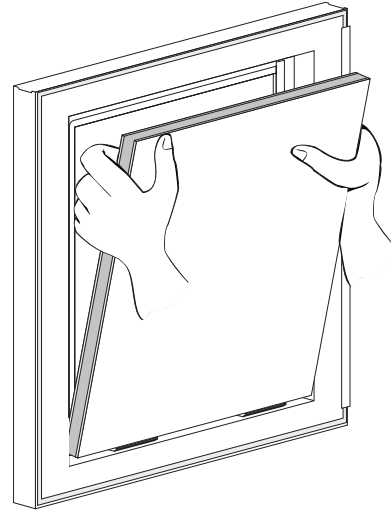

5

Keeping the insulated unit as parallel to the frame as possible, place the bottom of the IG unit on the set blocks inside the glazing bed. Center the unit left to right and press the top into the frame against the glazing tape.

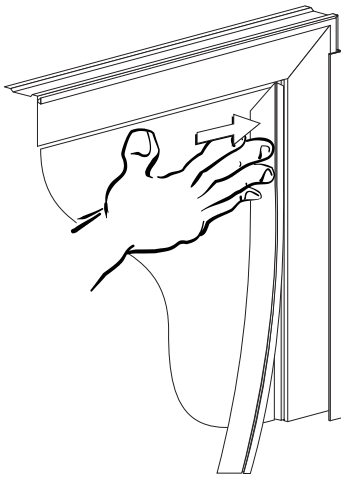

6

Align the mitered end of the glazing bead to the bead kerf in the corner of the frame. Apply pressure at fingertips against the bead and press into the kerf; working from the mitered end all the way to the square end.

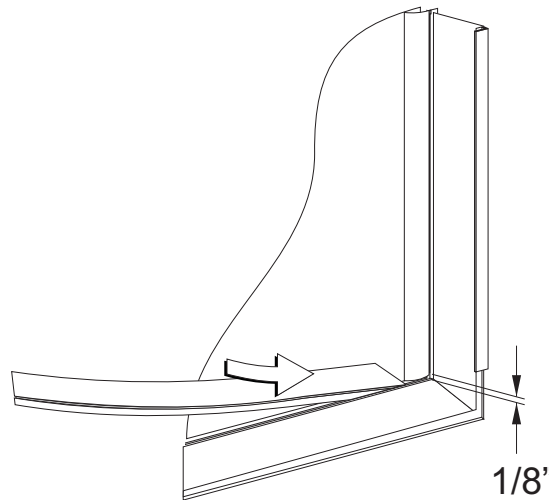

7

There should be a 1/8" gap where the bead falls short of the inside frame. This allows clearance for the overlapped mitered end of the next glazing bead. Press the mitered end of the next bead into the kerf and slide into the corner, laying over the 1st square end. Continue in a clock-wise pattern until the last bead is installed, tucking the square end behind the first miter end at the beginning.

Mitered ends overlap over square ends.

[Lookup Glazing Bead Part# in the Parts List](#)